

Based upon the Ordnance Survey mapping with permission of the Controller of Her Majesty's Stationery Office. ©Crown copyright. Unauthorised reproduction infringes crown copyright and may lead to prosecution or civil proceedings. Corporation of London 087254 - 2003. This mapping is provided by the Corporation of London under licence from the Ordnance Survey in order to fulfil its function to maintain and promote its open spaces for the recreation and enjoyment of the public. Persons viewing this map should contact Ordnance Survey Copyright for advice where they wish to licence Ordnance Survey mapping for their own use.

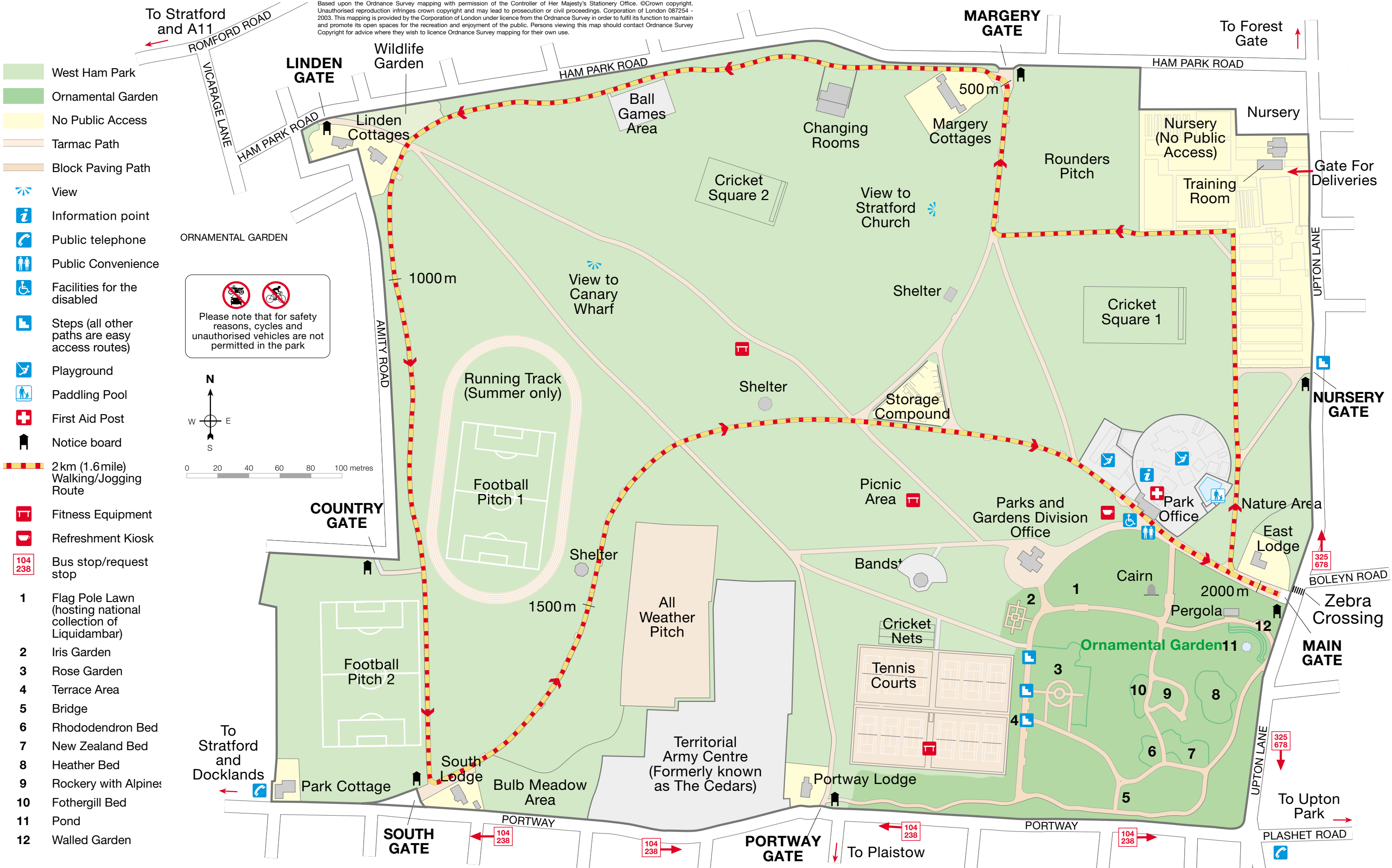

**Park opening** – The Park is open from 7.30am every day until dusk. The Toilets are open from 7.45am until 15 minutes before closing.

**Children's Playground** – The playground is open from 9.30am every day until 30 minutes before park closing time (8pm in the summer months).

**Catering** – An ice-cream van is available in the summer providing refreshments. Picnics are welcome and benches are provided in the Park.

If you would like to tell us your ideas for how the park could be improved, please call into the Park Office situated at the playground for a comments card.

**Want to get involved?** To find out more about helping to shape future plans for the park and volunteering opportunities please contact the Park Office on 020 8472 3584 or [parks.gardens@corpoflondon.gov.uk](mailto:parks.gardens@corpoflondon.gov.uk)

*West Ham Park*